

# CERTIFICATE OF LOCATION OF GOVERNMENT CORNER

EAST QUARTER Corner of Section 4, Township 107N, Range 39W

5th Principal Meridian, State of Minnesota, County of MURRAY

At the corner location shown on the sketch:

On 11/03/2020 found a 18X11X5" STONE DOWN 3FT LAYING FLAT. NO VISIBLE MARKINGS. REMNANTS OF WOOD  
DATE 11/03/2020 STAKE ON SOUTH SIDE OF STONE.

left monument as found  lowered monument  removed monument (explain)

On 11/03/2020 placed a NO. 4 REBAR WITH CAP LS 45874 ABOVE STONE.  
DATE

### SKETCH OF REFERENCE TIES

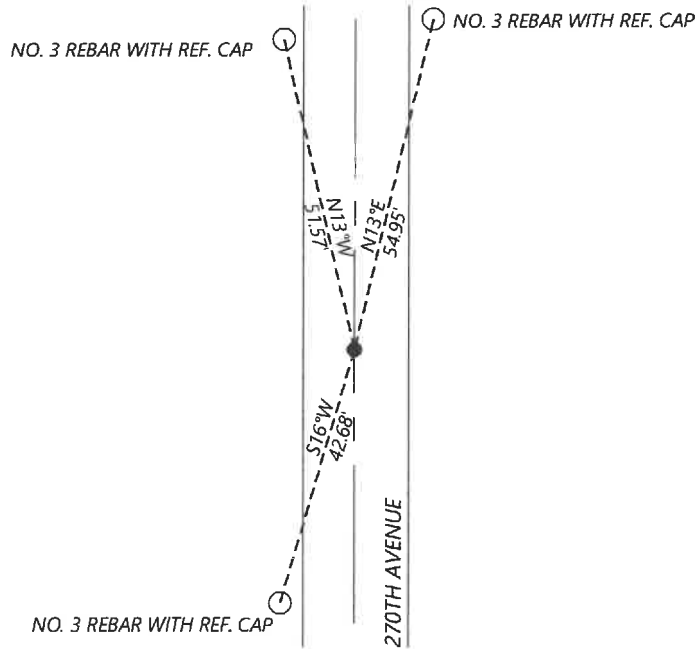

N.T.S.

Statement of evidence for this corner location is on back of this page.

I hereby certify that this document was researched and prepared by me or under my direct supervision and that I am a licensed Land Surveyor under the laws of the State of Minnesota.

Signature [Handwritten Signature]

Date 6/16/2021 License No. 45874

Title:

- Land Surveyor
- Professional Engineer
- County Surveyor
- County Engineer

OFFICE OF THE COUNTY RECORDER

County of Murray

I hereby certify that this document was filed in the Co.

Recorder's office at \_\_\_\_\_ M. on the \_\_\_\_\_ day of \_\_\_\_\_ A.D. 20\_\_\_\_\_

County Recorder Karen Brown

by JUN 22 2021, Deputy

DOCUMENT NO. \_\_\_\_\_

JASON LATZKE  
Minnesota License No. 45874

**Statement of Evidence:**

East Quarter Corner of Section 4, Township 107 North, Range 39 West, 5th Principal Meridian, Murray County, Minnesota.

1861 July, GLO Notes: Set post in mound.

1913 June, Survey record for Section 3 shows a stake at the corner. A distance of 2476ft is shown to the Northwest section corner.

2020 December, Westwood Professional Services excavated with a backhoe and found an 18x11x5" stone at a depth of 3ft with remnants of wood next to it. No other stones in the area. I accepted the found stone and set a  $\frac{1}{2}$ " rebar and cap LS 45874 above it, 0.5ft below road grade.

Analysis of the recovered data, field evidence and survey measurements, indicates that the monument found is the correct perpetuation of this corner. For additional information concerning this corner please contact Westwood Professional Services.